

# Components

## SNH & NH

### 1" Wide



- Two Terminals, One End (type SNH)
- One Terminal, Each End (type NH)
- 8 - 53-7/8" Lengths
- 250 - 1,500 Watts
- 120 and 240 Volt
- 7 - 24 W/in<sup>2</sup>

Dimensions (type NH)

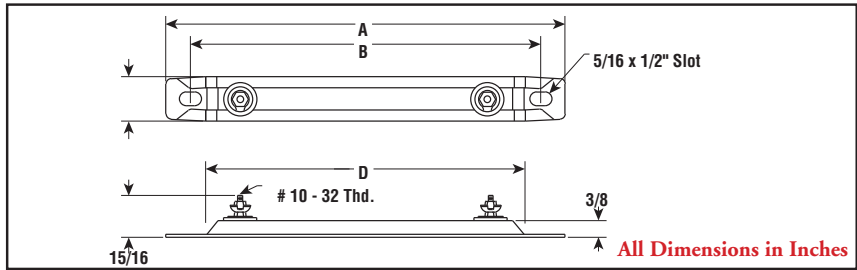

Dimensions (type SNH)

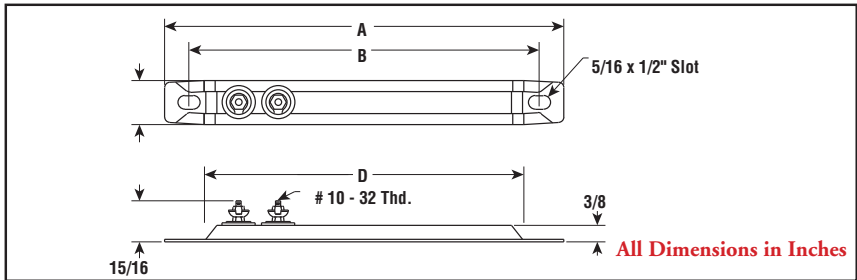

### Applications

Strip heaters are used for heat transfer by conduction or convection to heat liquids, air, gases and surfaces. See guidelines in the Strip Heater Overview section.

### Specifications and Ordering Information

Dimensions (In.)			Watts	W/in <sup>2</sup>	Chrome Steel Sheath				Chrome Steel Sheath				Wt. (Lbs.)		
A	B	D			Model	120V		240V		Model	120V			240V	
						Stock	PCN	Stock	PCN		Stock	PCN	Stock	PCN	
8	7	6-1/2	250	24	SNH-08	S	133727	—	—	NH-08	NS	133209	—	—	0.4
9-1/2	8-1/2	8	300	21	SNH-09	S	133735	—	—	NH-09	NS	133217	—	—	0.4
11	10	9-1/2	350	19	SNH-11	S	133743	—	—	NH-11	NS	133225	—	—	0.5
12	11	10-1/2	400	19	SNH-12	S	133751	S	133760	NH-12	NS	133233	—	—	0.6
14	13	12-1/2	450	17	SNH-14	S	133778	S	133786	NS-14	NS	133241	—	—	0.7
15-1/4	14-1/4	13-3/4	500	17	SNH-15	S	133794	S	133807	NH-15	NS	133250	NS	133268	0.8
17-7/8	16-7/8	16-3/8	600	17	SNH-18	S	133815	S	133823	NH-18	NS	133276	NS	133284	0.9
19-1/2	18-1/2	18	600	15	SNH-19	NS	133831	S	133840	—	—	—	—	—	1
19-1/2	18-1/2	18	700	17	—	—	—	—	—	NH-19	NS	133292	NS	133305	1
21	20	19-1/2	750	17	SNH-21	NS	133858	S	133866	NH-21	NS	133313	NS	133321	1
22-1/2	21-1/2	21	750	16	SNH-22	NS	133874	S	133882	—	—	—	—	—	1
23-3/4	22-3/4	22-1/4	300	7	—	—	—	—	—	NH-24	NS	133330	NS	133348	1
23-3/4	22-3/4	22-1/4	800	16	SNH-24	NS	133890	S	133903	—	—	—	—	—	1
25-1/2	24-1/2	24	900	16	SNH-25	NS	133911	NS	133920	—	—	—	—	—	1.1
27-1/2	26-1/2	26	900	14	SNH-27	NS	133938	NS	133946	—	—	—	—	—	1.1
28-3/4	27-3/4	27-1/4	1,000	16	SNH-28	NS	133954	S	133962	—	—	—	—	—	1.3
30-1/2	29-3/8	28	1,000	15	SNH-30	S	133970	S	133989	—	—	—	—	—	1.3
33-1/2	32-3/8	31	1,000	14	SNH-33	NS	133997	S	134009	—	—	—	—	—	1.4
35-7/8	34-3/4	33-3/8	1,000	13	SNH-36	NS	134017	S	134025	—	—	—	—	—	1.5
38-1/2	37-3/8	36	1,250	15	SNH-38	NS	134033	NS	134041	—	—	—	—	—	1.6
39-7/8	38-3/4	37-3/8	1,250	14	SNH-40	NS	134050	S	134068	—	—	—	—	—	1.6
42-1/2	41-3/8	40	1,250	13	SNH-43	NS	134076	NS	134084	—	—	—	—	—	1.8
43-7/8	42-3/4	41-3/8	1,250	13	SNH-44	NS	134092	NS	134105	—	—	—	—	—	1.8
45-7/8	44-3/4	43-3/8	1,500	14	SNH-46	NS	134113	S	134121	—	—	—	—	—	1.9
47-7/8	46-3/4	45-3/8	1,500	14	SNH-48	NS	134130	NS	134148	—	—	—	—	—	2
50-7/8	49-3/4	48-3/8	1,500	13	SNH-51	NS	134156	NS	134164	—	—	—	—	—	2.1
53-7/8	52-3/4	51-3/8	1,500	12	SNH-54	NS	134172	NS	134180	—	—	—	—	—	2.3

Stock Status: S = stock NS = non-stock  
To Order—Specify model, PCN, watts, volts and quantity.